



PT. LIMAS BERKAT ABADI

COMPANY PROFILE & PRODUCT CATALOGUE



ALMAR

Guarantee Your Needs

ONE STOP SOLUTION

WWW.LIMASBERKATABADI.COM



PT. LIMAS BERKAT ABADI

WWW.LIMASBERKATABADI.COM

TABLE OF CONTENT

About Us	02
Almar Modular SGP For MOT System	04
Modular Operating Theatre	05
Medical Equipment	06
Ceiling Pendant System	06
Almar Scrub Sink 2 Bay	08
Almar Dynamic Pass Box Stainless Steel SUS-304	08
Almar Pass Box Stainless Steel SUS-304	08
Accessories Modular Operating System	09
Almar X-Ray Viewer	09
Almar Medical Storage Cabinet	10
Almar LED Operating Theatre	10
Almar PB Lead Sheet	11
Almar PB Glass/Anti-radiation Glass	11
Almar Control Panel	11
Almar Information Panel	12
Almar LED Light	12
Almar Power Ground Module	12
Door System	13
Fire Door	13
Swing Steel Door & Swing Door PB Lead	14
Stainless Steel Door	15
Sandwich Panel Door	16
Shaft Door	16
Automatic & Hermetic Door System	17
Automatic Swing Door	18
ICU/HCU Automatic Sliding Door	19
Almar Hermetic Auto Sliding Door	20
Almar Hermetic X-Ray Auto Sliding Door	21
Almar Hermetic Auto Swing Door	22
Almar Linac Door	23
Almar Manual/Automatic Door For Emergency Evacuation	24
Almar Automatic Telescopic Door	25
Accessories	26
Panel System	27
Insulate Panel System	27
Joint System & Accessories	30
HRP Antibacterial	32
Test Result Certification	33
OT Layout 3D Design	34
All Door Layout 3D	36
Product Reference	38
Project Reference	40
Partnership	44

ABOUT US

In line with rapid development in this country, and also fully supported by government programs, we are here as a national development partner to fully support progress in the construction sector. PT. Limas Berkata Abadi come with experience of the company founders, and employees. PT. Limas Berkata Abadi is fully committed to professionally providing the best work by prioritizing quality and always working together to prioritize customer satisfaction. The trust given by various parties, namely the government, the private sector, and individuals has created various construction works from installations to make us an expert and trusted in hygienic and architectural space sector. With the principle of "One Stop Solution" we are ready to provide the best installation services and providers. Also always maintaining the best quality and foremost in after-sales service. PT. Limas Berkata Abadi is always ready for customers and be a trusted solution at the right time, competitive prices, and especially the best solution.

Company : PT. Limas Berkata Abadi
Office : Ruko Ayodhya Square Blok A No.15
Jl. MH Thamrin Cikokol, Tangerang (15117)
Phone : 081546149393 & 087888596964
Email : limasberkatabadi@gmail.com

Vision

Be the best & become the first choice of customers, as well as trusted as partner who prioritizes professionalism, trust, commitment, and consistency in maintaining output and quality, as well as contributing to the development and economy of the nation with the value of local wisdom.

Mission

1. Provide products and services in the construction sector.
2. Serve customers with high quality and become professionals with the value of sincerity and honesty.
3. Understand and fulfill what the customer needs effectively and efficiently.
4. Build job and provide opportunities for young professionals to work.

Our Strengthness

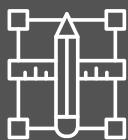

Customized
Modular
Design



Industrial
Standardized
Production



Fast &
Efficient
Installation

Core Business & Area

- Radiology Room
- Customization Door
- Stainless Steel Door
- Sandwich Panel Door
- Automatic Swing Door
- Automatic Sliding Door
- Medical Equipment
- Modular Operating Theatre
- Hermetic Door
- Linac Door
- Economic Door
- Steel & Fire Door
- Panel Door



Distribution Area

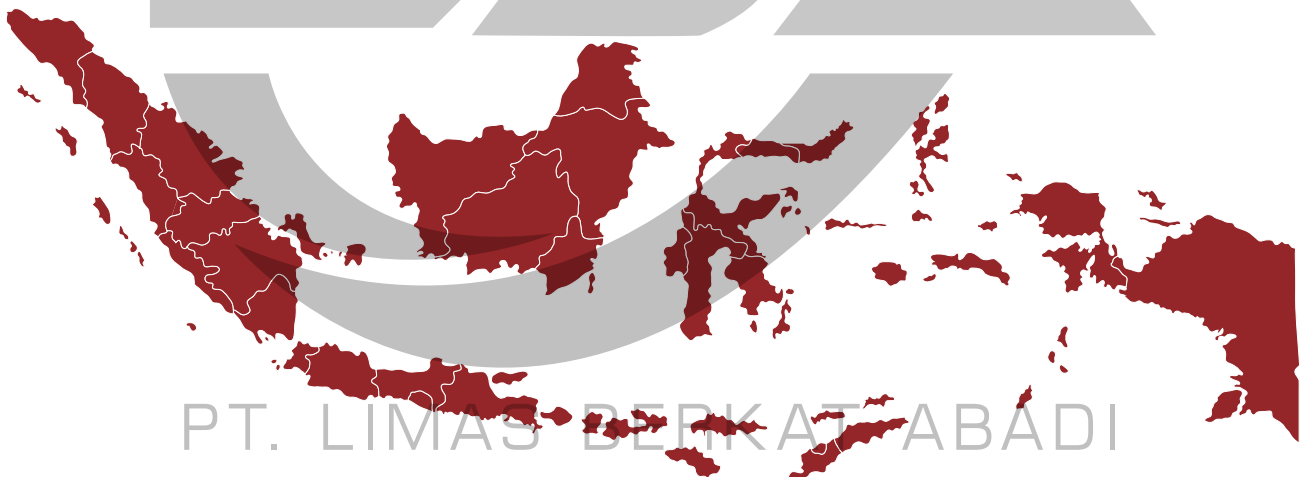

Banda Aceh | Sabang | Medan | Pematang Siantar | Jambi | Batam | Palembang
Serang | Tangerang | Bogor | Depok | Jakarta | Bekasi | Bandung | Cirebon | Cimahi
Pekalongan | Semarang | Surakarta | Yogyakarta | Kediri | Malang | Magelan | Blitar
Surabaya | Bali | Lombok | Pontianak | Gorontalo | Balikpapan | Banjarmasin | Bima
Samarinda | Pekanbaru | Manado | Ujung Pandang | Ambon | Kupang | Jayapura

Almar Modular SGP For MOT System



Almar Modular SGP (AL-SGP-AB5)

- Surface : Powder coated galvanized steel. (EGI + Polyester Coated) 0.8 mm + common gypsum board (12.5 mm).
- Heat insulator & sound blocking material polyster rockwool density 100 kg.
- Non-bearing wall space division that is not loaded by architecture building.

Product Charateristics

The modular wall system cam adopt to the most varied building conditions.

The framework is formed by substructure.

The color of wall are available in version color.

We provide the products inspe etd an certificated with anti-bacterial coating and natural ingredient, which inactives bacteria or inhibits their growth.

We offer a construction-kit for functional and extensively equipped areas with demand on high quality regarding surface & function.

Product Description

Outside layer is PCM 0.8 T + Gypsum board 12.5 T.

Inside layer is fire & waterproof gypsum board modular partion or PIR

45 kg/m³ system in hospital room suitable quality.

Individual components are easy to dissamble & replace.

Surface used powder coated according to RAL (By Requested).

Panel thickness : Approximately 15 mm.

Width dimension : 1160-1180 mm.

Partition height : 3000 mm.

Panel dimension : Approximately (1160-1180) x 3000 mm.

High performance thermal & noise insulation panel.

Using insulation with rockwool density 100 kg or PIR 45 kg/m³ density.

Cable recessed & empty conduits and cable trays.

Silicon (antibacterial quality).

Rubber backpacking.

Option : Color.

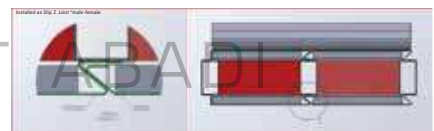
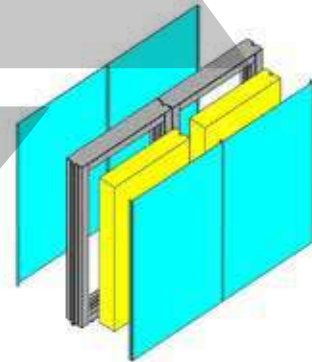

Available Custom Color



C-304 (Ivory)



D-39812 (S)



WS3



K/Green (S)



EB3



C-705 (White)



C-417 (Green)



D-54694 (S)

MODULAR OPERATING THEATRE

3 Models of Modular Operation Theatre



Insulated Panel

Insulated metal wall panel profiles energy efficient building as well as the insulated R panel, all with unique profiles, features and benefits. As codes and regulations continually call for sustainable building material, our interior and exterior insulated metal panels offer numerous advantages over other construction products.

Wall Glass Panel

Glass is the material which is extremely tough, fireproof and steady to meet the surgeons and the highest hygienic requirement. No limits on glass in design, colors, patterns for graphics can be put on it per customers request.



Stainless Panel

All wall panel are clipped-into the support frame which allows future removal or changes on individual panel, the re-installation or wall panel repair work would be without.

PT. LIMAS BERKAT ABADI

Ceiling Pendant System



Single Arm Manual Surgical Pendant (AL-PDDMM-S2)

Single Fixed Arm version consists of central ceiling with rotation axle and one moveable carrying arm. Various service head can be attached to interface flange.

- Arm length : 1000 mm.
- Rotating angle : 340°
- Bearing weight : More than 87 kg.
- Locate freely with automatic brake.
- Gas source terminal optional (German style/American style/British style).

Double Arm Manual Surgical Pendant (AL-PDDMM-D2)

Double Fixed Arm version consists of central ceiling mounting with rotation axle and two moveable carrying arms. Various service head can be attached interface flange.

- Arm length : 750+750 mm.
- Rotating angle : 340°
- Bearing weight : More than 87 kg.
- Locate freely with automatic brake.
- Gas source terminal optional (German style/American style/British style).





Single Arm Electric Surgical Pendant (AL-PDDMM-S2E)

- Arm length : 1000 mm.
- Rotating angle : 340°
- Lift range : 500 mm.
- Lift speed : 20 mm/s.
- Bearing weight : More than 87 kg.
- Locate freely with automatic brake.
- Gas source terminal optional (German style/American style/British style).



Double Arm Electric Surgical Pendant (AL-PDDMM-D2E)

- Arm length : 360+930 mm.
- Rotating angle : 340°
- Lift range : 500 mm.
- Lift speed : 20 mm/s.
- Bearing weight : More than 87 kg.
- Locate freely with automatic brake.
- Gas source terminal optional (German style/American style/British style).

Almar Scrub Sink 2 Bay (AL-HLSS2B)



Available Custom Size

Description	Dimension (W . D . H)
1 Person	800 x 600 x 1550 mm
2 Person	1600 x 600 x 1550 mm
3 Person	2100 x 600 x 1550 mm
Or Custom Size	

Product Specifications :

- Material SUS 304 thickness 1.2 mm.
- Available in 1, 2, and 3 washing station.
- Dimension 1600 x 600 x 1550 mm/Custom size.
- Water heater - Included (In one system/integrated)
- Using automatic sensor system & manually system for emergency use.
- Hand dryer, auto soap system is included.
- Using sterilized ultraviolet lamp system.
- Using filtering system for 5 micron or can be custom, based on requested.
- With 2 bay faucet automatic system & 2 foot system for manual used.
- With safety system electricity to avoid leakage electricity.
- Low cost electricity consumption, AC 220 volt, 50 hz, 250 watt.

Almar Dynamic Pass Box Stainless Steel SUS-304 (AL-MPB-8050) Double Pass Through Box Interlock System Module



Product Specifications :

- Made from stainless steel SUS 304.
- Dimension 1400 x 800 x 500 mm Ex.Almar.
- With 2 lamp indicator red & green.
- With UV lamp & timer activation auto running once door open system Ex.Almar.
- Two side open interlock door-system PLC Ex.Almar.
- With TL lamp.
- With booster fan CKE.
- Electronic control panel.
- Pre filter & HEPA filter.
- With fluorescent lamp & push button function.
- Full warranty 1 year for service & spare part.
- Differential pressure gauge (Magnehelic).

Almar Pass Box Stainless Steel SUS-304 (AL-MPB-8050)



Pass Box

At generally Pass Box also used in the clean and cleanless area. Pass Box also used in micro technology, bio technology laboratories, pharamaceutical and electronics factory.

Product Function :

- It has the function of air valve to prevent high presure to leak in the clean room.
- It can reduce the time when operating personel walk to prevent bring dust in and keep the stability of the clean room.

ACCESSORIES MODULAR OPERATING SYSTEM

Almar X-Ray Viewer (AL-VB-2NC)

Almar X-ray Viewer Box is a part of Medical Equipment which is based on LED X-ray illuminator. Keeping the needs of doctors in mind along with the continuously changing demands of hospitals and nursing homes. Our X-ray Viewer can be effective LED Viewing System to view MRI, CT, and X-ray.



Types

1. Single Screen - 1NC
2. Double Screen - 2NC
3. Triple Screen - 3NC

Product Features :

- Slim, Durable and Energy Effective.
- Efficient, Savings range from 82% to 93%.
- No UV Emission.
- Unparallel latest LED backlight technology, 4-5 times longer than regular CCFL/EEFL.
- Power Efficient, LED light with long life up to 100.000 hours.
- Initial Brightness can be set.
- Film activation switch automatic shutdown if no film inserted.
- 12 step digital dimmer to get the perfect brightness.
- Light : Parallel uniformity brightness uniformity : > 90%.

Screen		Single Screen	Double Screen	Triple Screen	Quadruple Screen
Dimensions (W.H.D)	Frame (W.H.D)	503 x 503 x 29 mm	880 x 503 x 29 mm	1255 x 503 x 29 mm	1631 x 503 x 29 mm
	Viewing (W.H)	360 x 440 mm	736 x 440 mm	1112 x 440 mm	1488 x 440 mm
Power Consumption		15 W	30 W	45 W	60 W
Light Source		LED	LED	LED	LED
Power Supply Input		AC 100-240 V 50/60 Hz	AC 100-240 V 50/60 Hz	AC 100-240 V 50/60 Hz	AC 100-240 V 50/60 Hz
Brightness (LUX)		> 10.00	> 10.00	> 10.00	> 10.00
Net Weight (Kg)		4.8	8.8	12.4	16
Color Temperature		5,900 - 9,000 K	5,900 - 9,000 K	5,900 - 9,000 K	5,900 - 9,000 K
Luminance Adjustment		20% - 100%	20% - 100%	20% - 100%	20% - 100%



Almar Medical Storage Cabinet

Medical storage cabinet made by stainless steel SUS 304 grade, easy of cleaning and anti rust material. By using medical storage cabinet, it's guarante to keep medical equipment are safe & sterile.

Almar Pacs Cabinet (AL-HLOC-1220)

Material : Stainless Steel
Dimension : 1200 x 2000 x 4000 mm
or Custom size.

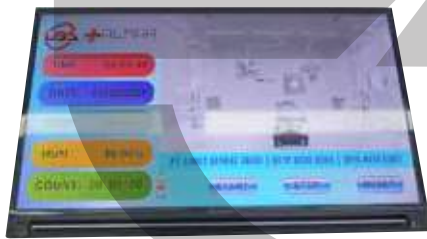

Almar LED Operating Timer (AL-OTINT-01)

Because of the larger number shape, so that it can be seen more clearly even from a long distance. Using electric power as a source of energy. If the electricity is off, the clock will off. But the time will be automatic updates if the electricity is on again (no need to reset).

Product Features :

- Display countains bright red segment LED.
- Enter the characters on the screen using the thermo humidity sensor and keypad.
- There are digital number setting in the date, time and count down fields.
- Use an average maximum power of 80 watts.
- Input voltage of 20 volts AC.
- Material made of alumunium anodize with black .
- PCB uses double layer fiber (FR4) which is resistant to heat and not easy to corrade.
- Display TV LED 32 Inch.
- With digital system programming.
- Developed system by LBA.



Almar PB Lead Sheet (Certificate Based)

Lead sheet is used as a protective or coating on the radiology room in the hospital. This product is made from pure tin levels close to 100% so it has perfect radiation resistances.

Dimension : 1 mm, 1.5 mm, 2 mm, 3mm.

Almar PB Glass / Anti-radiation Glass (Certificate Based)

PB Anti-radiation Glass can be used effectively in X-ray / CT-Scan rooms, radiotherapy rooms, surgical rooms, laboratories, material testing, and many other applications because it provides protection against radiation. This PB glass is transparent and allows X-ray or CT-Scan room operators to monitor the process of taking pictures or radiation therapy.

Thickness : 15 mm / 20 mm.

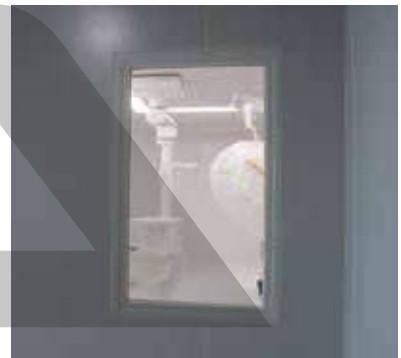

Almar Control Panel (AL-LCCPT-1)

- 32 gb of storage and expandable 500 gb external storage.
- OS : With mini PC digital.
- Zoom : 16:9.
- Resolution : 1920 x 1080, Support 10 touch & high resolution.
- Surface hardness : > 6 h.
- Wireless network bluetooth 4.0.
- Wifi and USB 2.0 transmission.
- Emergency System : One-button emergency start.
- App : Mobile App remote synchronization operation monitoring,
- PC-side cloud monitoring service platform, real-time monitoring.
- CPU : A7 eight-core processor, 4 gb of running memory/custom updated.



Almar Information Panel & System Integrated (AL-IP-01)

- Material : LED TV 32" or above (can).
- Dimension : 610 x 1050 x 200 mm.
- Software developed by Limas & can integrated to another trigger.
- Enable to install if necessary : Air control box, Power switch, etc.



Almar LED Light (AL-1230P)

- Dimension : 1200 x 300 x 22.5 mm



Almar Power Ground Module (AL-MPGM)

- Dimension : 608 x 150 x 70 mm.
- 3 Double electric socket.
- 1 Power receptacle.
- 2 Ground jack.

DOOR SYSTEM

Fire Door

Fire emergency doors are metal doors that can withstand fire for a certain period of time to prevent the spread of fire and smoke. Mostly applied for the emergency corridor of a building.

Fire emergency exit are designed using insulation materials, generally using rockwool, so that they meet fire protection requirements, and are installed on the door leading to the emergency staircase.

Available single and double door.



• Fire Single Door

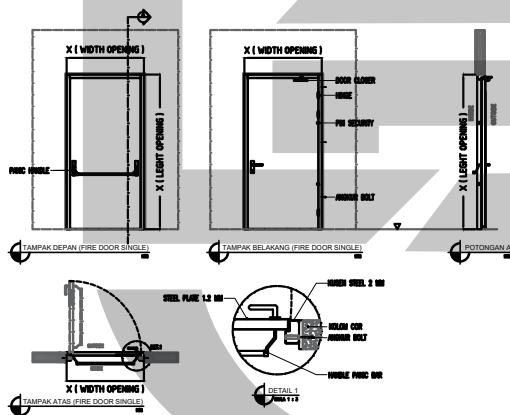

• Fire Double Door

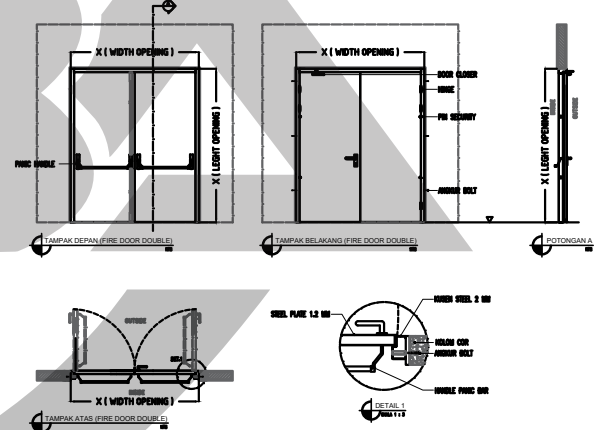

FIRE DOOR		Single Door	Double Door
Dimension Size		1000 x 2200 mm	2000 x 2200 mm
Insulation		Rockwool 100 kg/m ³	
Glass		Glass Vision/without	
Material	Frame	Steel Plate 2 mm	
	Door Leaf	Steel Plate 1.5 mm	
Door Leaf Thickness		50-55 mm	
Finished		Powder Coating Color	
Accessories		(Onassis, Wilka, Calvis, Griff, Dekson, Kend, etc.)	
or can be custom size			



Swing Steel Door & Swing Door PB Lead

Steel door designed to meet the needs of doors that have high durability. Made of steel plate with reinforcing bones inside the door leaf, so as to produce a rigid door surface and make the door impact resistant.

Available single & Double door.

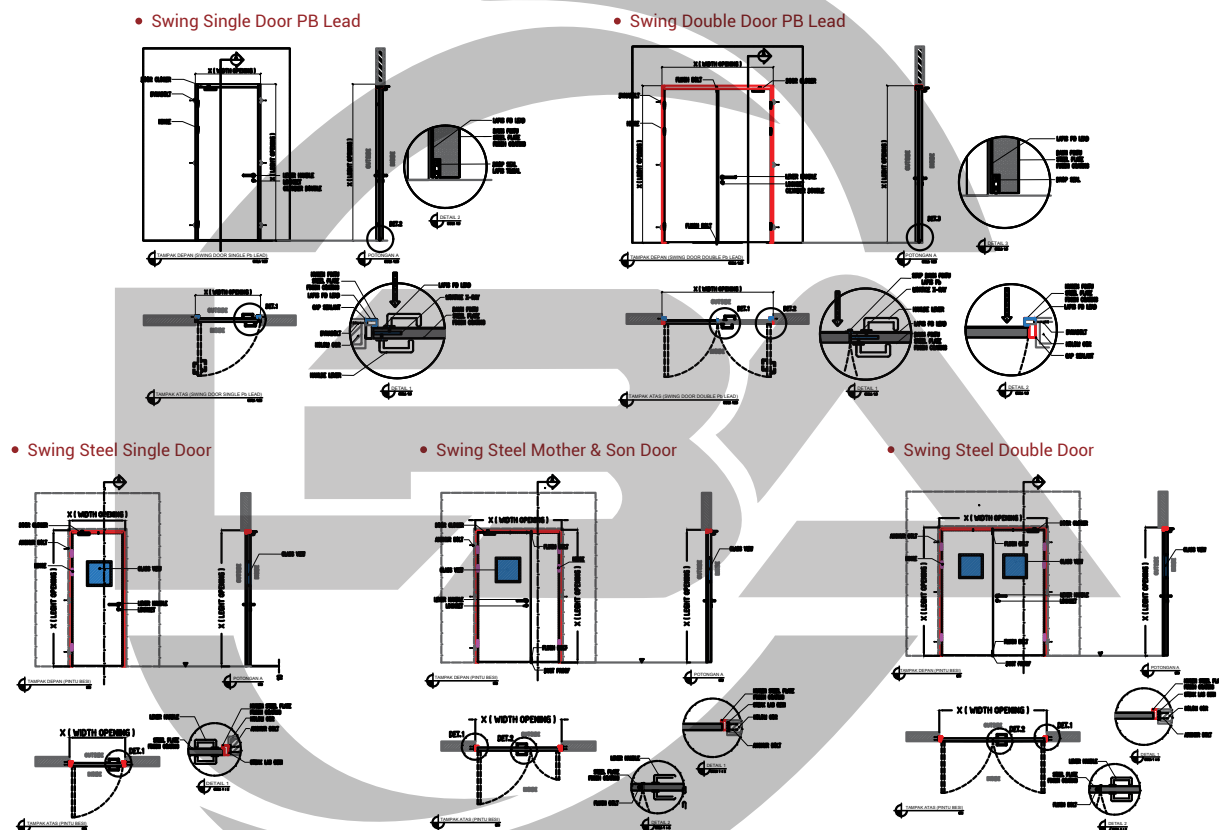

STEEL DOOR		Non PB Lead		With PB Lead	
		Single Door	Double Door	Single Door	Double Door
Dimension Size		1000 x 2200 mm	2000 x 2200 mm	1000 x 2200 mm	2000 x 2200 mm
Insulation		Rockwool 80 kg/m 3		PB Lead (Plywood 9 mm + Rangka Hollow)	
Glass		Glass Vision/without.		View Glass Timbal.	
Special		-		With mortise x-ray special. (Developed by LBA)	
PB Glass		-		View Glass Timbal.	
Material	Frame	Steel Plate 1.8-2 mm			
	Door Leaf	Steel Plate 1.2-1.5 mm			
Door Leaf Thickness		+/-50 mm			
Finished		Powder Coating Color/Stainless Steel			
Accessories		(Onassis, Wilka, Calvis, Griff, Dekson, Kend, etc.)			
Can be custom size					

Stainless Steel Door

The high quality Stainless steel door of SUS 304 allows you no need to clean it too often, because this Stainless steel door can be said Anti-bacterial and last for a long time. Among the contributing factors is that this material is anti-rust and is not easily deformed.

Available single & double door.

Single Door	Double Door
-	Flush Bolt
Polyisocyanurate (PIR)	
View Glass	
Steel Plate 2 mm	
Hinge 4 x 3 x 3 2bb	
Doorcloser	
Cylinder	
Lever Handle	
Lockset	

• Stainless Steel Swing Single Door

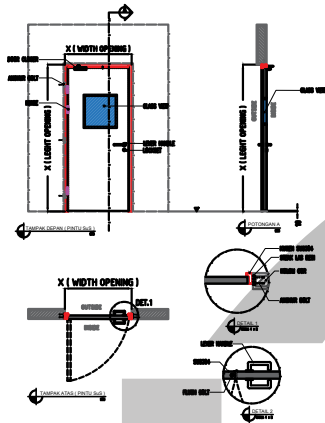

Without Glass



With Glass

• Stainless Steel Swing Double Door

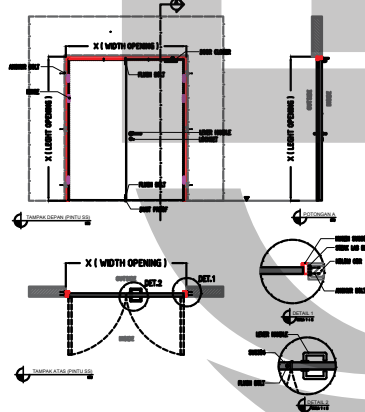

Without Glass



With Glass

• Stainless Steel Swing Mother & Son Door

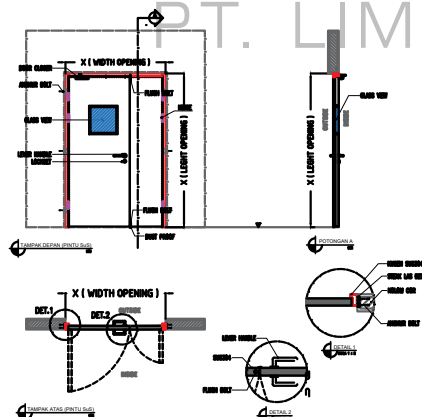

Sandwich Panel Door

Made of PU or EPS sandwich panels with a thickness of 50 mm, combined with a frame that uses aluminum adapted to the needs. This door is termite-proof and water-resistant so it can be applied outdoors or indoors because it will not be brittle by the weather. Can be applied to hospital doors, Lab doors. Chemistry, the door of keet's attention.

Available single and double door.

Standard Clear Opening

Single : 1000 x 2.150 mm
Double : 2000 x 2.150 mm
Can be custom size
(as per requested)



• Single Door

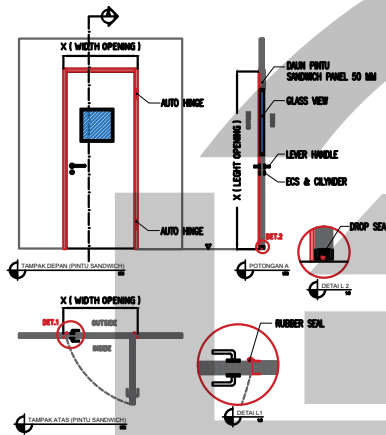

• Double Door

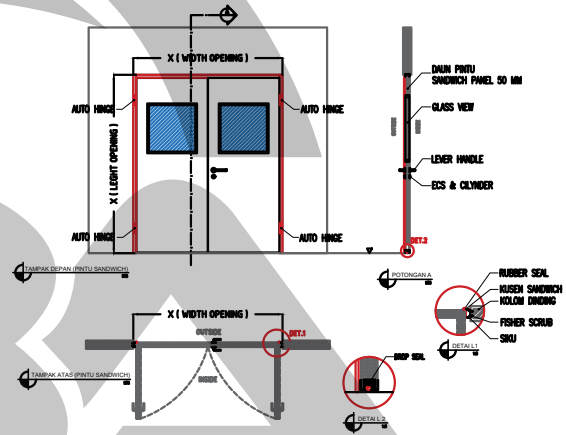

Shaft Door

Shaft Door is a door that has a high standard. It is suitable for mounting on the shaft of the room. The shaft is a tracking hole between one floor to another, for laying utility pipes, electrical cables vertically and others.

Available single & double door.



• Single Door

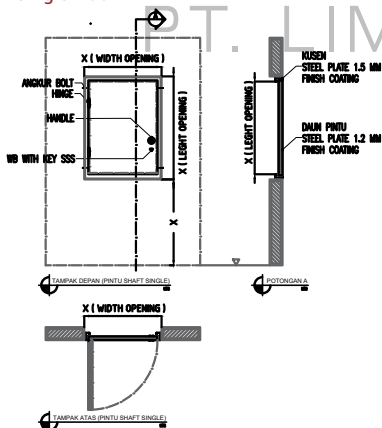

• Double Door

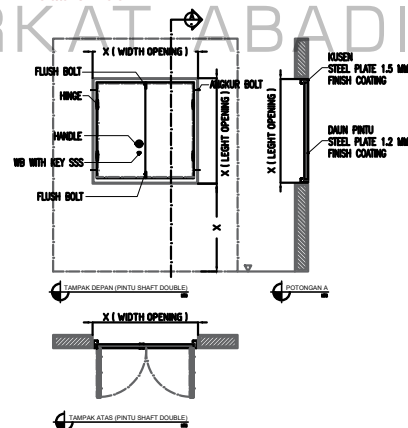

AUTOMATIC & HERMETIC DOOR SYSTEM



OUR STRENGTHNESS



AIR TIGHTNESS & ANTI BACTERIAL

Running smoothly in ward area, the light automatic medical doors are designed with patented technology, smart & quite in operating. Almar drive system is approved certification & the central gated control device can be used in pharmacies and other regional security areas.



INTELLIGENCE & SAFETY

ALMAR medical doors could well meet the clean door system functional requirements of hospital environment, and also adapt to the individual needs of patients and visitors.



IN HOUSE PRODUCTION & CUSTOM DESIGN

Created, Produced, Fabrication, After Sales By LBA.

PT. LIMAS BERKAT ABADI



FUNCTION & HOMMIZATION

ALMAR medical doors could well meet the clean door system functional requirements of hospital environment, and also adapt to the individual needs of patients and visitors. The Hospital channel desingned to make patients and visitors comfortable and more conducive to patinet's recovery.



DIVERSITY & RELIABILITY

Due to its architectural structure and the special circumstances, the challenges of hospital buildings faced by the building management system are to adapt the concept of function room. The ALMAR medical doors using a variety of linkage methods and start methods are to meet the individual needs of different customers, table & reliable operation.



ELEGEANT DESIGN & SIMPLICITY

Elegant design & bright color endow ALMAR medical doors with harmony and wholeness to the hospital environment. The novel design of high precision not only guarantees the products performance but also shows the perfect design sense.

Automatic Swing Door

Automatic swing door is a device that operates swing doors for pedestrian use. It helps open and close the door automatically.

Available single and double door.



• Single Door

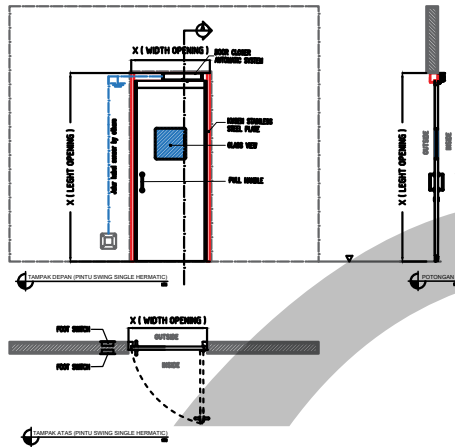

• Double Door

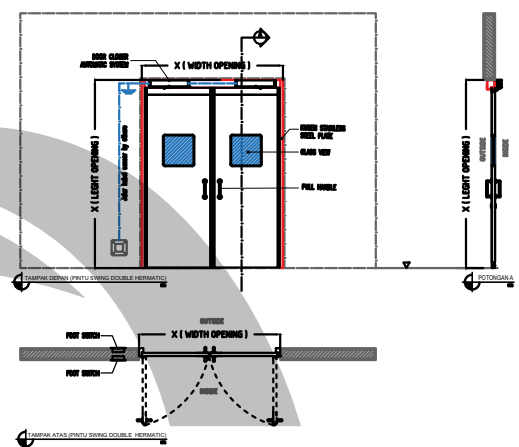

Triggers & Activators :

Detection	Wired Range	Wireless Range	Control
Movement sensor	Push button	Push button	Emergency stop
Reopening photocell	Elbow push button	Elbow push button	Buzzer and/or warning light
Standard presence sensor	Key switch	Key switch	
Unsupervised movement & presence sensor	Proximity reader	Keypad	
Supervised movement & presence sensor	Keypad	Remote control	
Touchless switch	Autonomous print reader	Handsfree access identifier	



Mechanical Specifications	
Dimensions	90 x 210 mm (1 leaf) 2x (90 x 210) mm (2 leaf)
Max. leaf weight	250 kg
Opening time	3s (70°/2) : 6s (20°/s)
Closing time	4s (40°/2) : 15s (10°/s)
Closing force	EN4 + EN6
Max. opening angle	110°
Width of door leaf	700 : 1400 mm
Anticrushing	Automatically limits force when obstacles are detected
Weight	Approx. 11 kg
Protection grade	IP40
Electrical Specifications	
Power supply	230 + -10% CA 50/60 Hz
Nominal power	85 W
Shaft output max torque	45 Nm
External device power supply	15 VDC - 12 W Max
Operating temperature	De-10° C a 50 C
Service	Continual
Applied Standards	
Low voltage	35/2014/CE
Electromagnetic compability	30/2014/CE
Construction materials	305/2011/CE
Machine safety	42/2006/CE
Automatic door use safety	EN 16005

ICU/HCU Automatic Sliding Door AL-ADIHC-01

- Highly intellectual design, high self-adaptation ability, high functional coverage.
- Independent soft track rail, silent operation.
- Quickly open & close, speed improves 20% than the traditional one,
- Self locking motor, high functional expansibility.
- Low powerconsumption, wide range of application.
- Long service life, high security, high reability.
- Easy installation, adjustment and maintenance.



• Auto Sliding Door

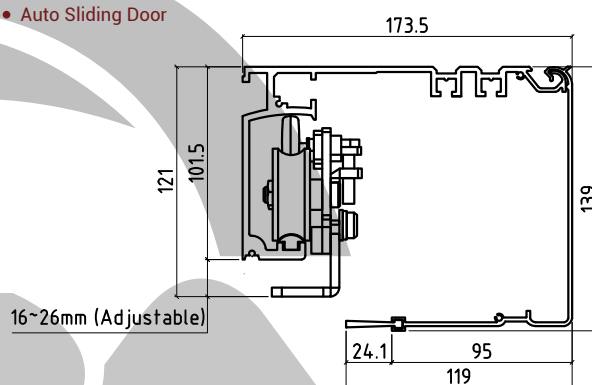

IDLER PULLEY
Adjust tension of puley
keep door move stable.

SYNCHRONOUS
High efficiency synchronous belt,
drive door foward and backward
with help of hanger.

MICRO-CONTROLLER SYSTEM
Integrated micro-controller chip, detect signals
from sensors. Function programmable and
adjustable according to door size & weight.

Automatic Operator

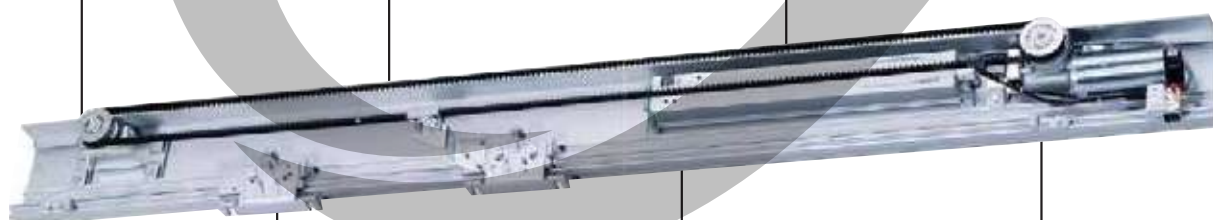

ALUMINIUM CASE
Made of high strenght
aluminium, super-looking
surface & robust structur.

ADJUSTABLE DOOR HANGER
All parts stamped by cold rolling steel,
easy to install door & adjust its height.
Coating with Dacromet technology, and
special guide pulley are equipped on the
hanger, and movingsmothly the
arcrailway on the power beam.

TRACK RAIL
Independent track rail, cassy to
replace & maintenance. High
quality rubber between track
rail & case elinminate noise &
vibration.

GERMAN BRUSHED DC MOTOR
High efficiency, High power dorsity,
Maintenance-free.

Door Weight	Single (150 kg)	Double (150 kg x 2)	
Door Width	700 - 2100 mm	650 - 1050 mm	
Door Close Lock Force	> 500 N	Work temperature	-20 - 50 C
Delay For Opening	2 - 20 s	Power voltage	AC 220 V +-10%, 50 Hz
Closing Speed	250 - 550 mm/s	Reverse time	< 1 s
Opening Speed	250 - 550 mm/s		

Almar Hermetic Auto Sliding Door AL-OTDM-01

Hermetic Auto sliding door the feature of environmental protection and energy saving are realized by the strong door plate, Effective opening and closing system that minimize the air flux, so that the cold air, dust will be isolated outside and the temperature wetness inside room well keep.

Available single and double door.



Product Feature :

- The track rail and door plate are mounted onto the wall, installed easily & fast.
- Tubular handle outside, recessed handle inside, ensure fully open of door leaf.
- Operating quietly & fast, good performance in sound insulation.
- The features of environmental protection & energy saving are realized by the strong door plate and effective opening and closing system that minimize the air flux, so that the cold air and dust will be isolated outside and the temperature and wetness inside room well kept.
- Humanized barrier free design provides the max convenience and safety to the patients and wheel barrows.

Product Description :

- Made of Stainless Steel.
- Glass cell : 5 mm thick.
- Electric Lock.
- Electric Motors.
- Battery backup.
- Dimension : 1600 x 2100 mm.
- Voltage : 220 VAC, 50/60 Hz.
- Labor assistant switch (Foot switch).
- Control & Opening in sensor, the sensor is mounted inside & outside the operating room.
- Speed : 0,7 m/ sec : door leaf, - 1.4 m/ sec : 2 door leaf.
- Power auto volt 85 - 264 VAC.
- Automatic motor reversal when there are obstacles, including pair of safety lights.

Clear Opening	1600 mm
Single (small)	900 x 2150 mm
Single (large)	1600 x 2150 mm
Double	1800 x 2150 mm

Tubular handle outside, recessed handle inside, ensure fully open of door leaf. Will help effectively preventing cross infection and greatly enhancing the hygienic performance of hospital.

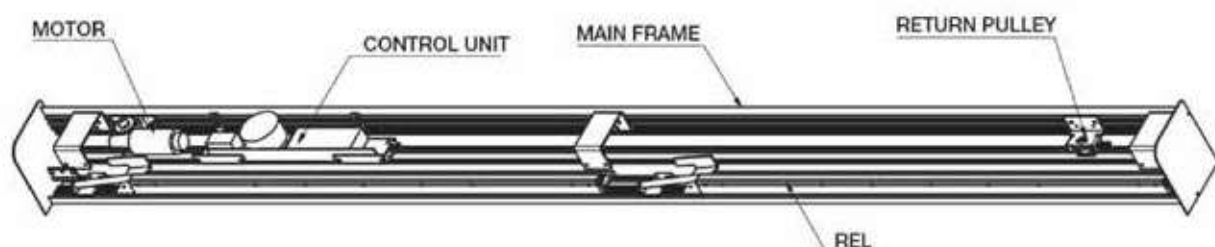

Almar Hermetic X-Ray Auto Sliding Door AL-OTDM-02

The Hermetic X Ray Auto sliding door has passed the inspection of institution protection lead sheed thickness 2mm is inside the door plate and wall frame.

X Ray Room according to aimed where required handling and special attention for safeties. Equip with lead plate inside of the door, guarantee to protect the people from X Ray Radiation.

Rubber seal strips are installed in the door frames and body, which will meet the hygienic requirement of hospital. The control system is designed accordance with the safety requirements of medical electrical system.

Available single and double door.



Clear Opening	1600 mm
Single (small)	900 x 2150 mm
Single (large)	1600 x 2150 mm
Double	1800 x 2150 mm

Product Feature :

- PB Lead sheet thickness 2 mm is inside the door plate and wall frame to shield the X-rays and protect human body against a variety of harmful rays.
- Hermetic Auto Sliding Door have passed inspection of the institution of radiation protection and nuclear safety.
- Rubber seal strips are installed in the door frames and door body, which will meet the hygienic requirements of hospitals and other places.
- The Control system is designed in accordance with the safety requirements of medical electrical system, and also multi-form control modes could be adopted according to the hospital requirements, that will not cause electromagnetic interface to other equipment at the same location.
- Booth automatic sliding doors and hermetic auto sliding door could be made to this kind of doors.

Product Description :

- PB lead : 2 mm.
- View glass : 15 mm (X-Ray Glass).
- Electric Lock.
- Battery backup.
- Dimension : 900 x 2100 mm.
- Voltage : 220 VAC, 50/60 Hz.
- Labor assistant switch (Foot switch).
- Control & Opening in sensor, the sensor is mounted inside & outside the operating room.
- Speed : 0,7 m/ sec : door leaf, -1.4 m/sec : 2 door leaf.
- Power auto volt 85 - 264 VAC.
- Automatic motor reversal when there are obstacles, including pair of safety lights.

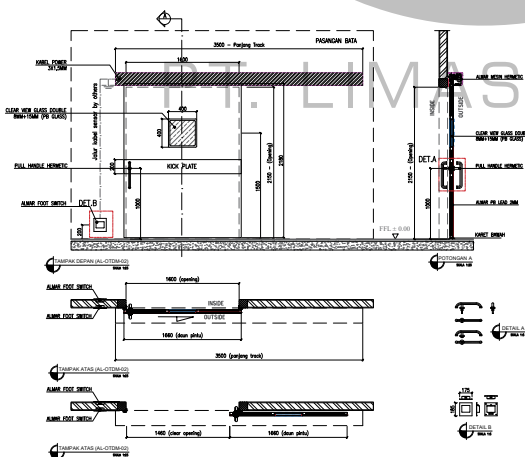

Almar Hermetic Auto Swing Door AL-OTDM-03

Hermetic Auto swing door operated by mounted on the door frame easy for installation. Door plate is made of high quality material stainless steel 304.

Along the door frames and the bottom there are rubber seal strips working together to well meet the sanitary requirement of hospital.

Available single and double door.



Product Feature :

- PB Lead sheet thickness 2 mm is inside the door plate and wall frame to shield the X-rays and protect human body against a variety of harmful rays or without PB.
- The X-ray shielding doors have passed the inspection of the institution of radiation protection and nuclear safety or without PB.
- High-strength sealing strips and various forms of door frames are available, meeting the hygienic requirements of hospitals and other buildings.
- The door can be made Steel sheet 304.
- The door frames and the bottom there are rubber seal strips.

Clear Opening	1000-2000 mm
Single	1000 x 2150 mm
Double	2000 x 2150 mm

• Single Door

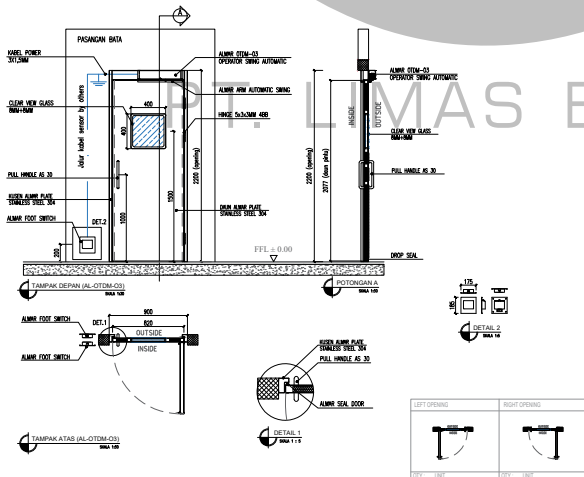

• Double Door

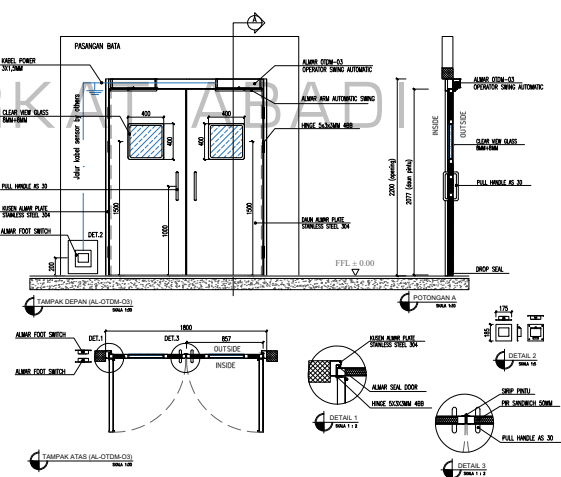

Almar Linac Door (AL-LINAC-01)

Linac Door for bunker room or Kemoteraphy room and Cobalt Door for Brachyteraphi room size dimension door leaf available customize.

Lead doors for radiodiagnosis and nuclear medicine, Borated polyethylene.

Specified Manufacturer: To establish a standard of quality, design, and function desired, drawings and specifications have been based on products manufactured by PT. Limas Berkas Abadi.

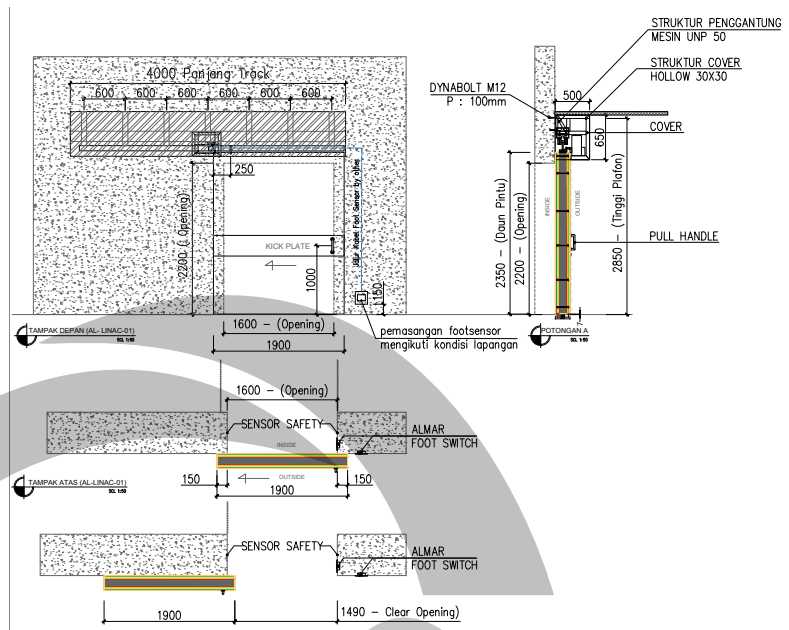

Almar Manual/Automatic Door For Emergency Evacuation

- The door is designed for emergency escape passage where a large number of pedestrian pass by, such as airport, bus station, hotel, hospital, supermarket, office building, schools & public buildings.
- Under normal circumstances, the middle leaves can move by sliding, and two fixed side doors cannot move. when emergencies happen, no matter it is sliding or closed, all the door leaves could be pushed rapidly as swing doors to maximize utilization of exit space.
- Operating quietly and fast, with good sound insulation effect. when meeting with obstruction, the door will rebound automatically to ensure the safety of passengers.

Door Type	4 Leaves	2 Leaves
Operator Standard Length	3000 - 4200 mm	2100 - 2700 mm
Standard Height	Fixed leaves 2200 mm	Active leaves 2170 mm
Voltage	AC 220 V +-10%, 50-60 Hz	
OpeningSpeed	250 - 550 mm/s (Adjustable)	
Closing Speed	250 - 550 mm/s (Adjustable)	
Open Delay Time	2 - 20 s (Adjustable)	
Manual Open Force	< 100 N	
Power Consumption	< 150 W	
Working Temperature	-20 - 49 C	
	Or custom size	

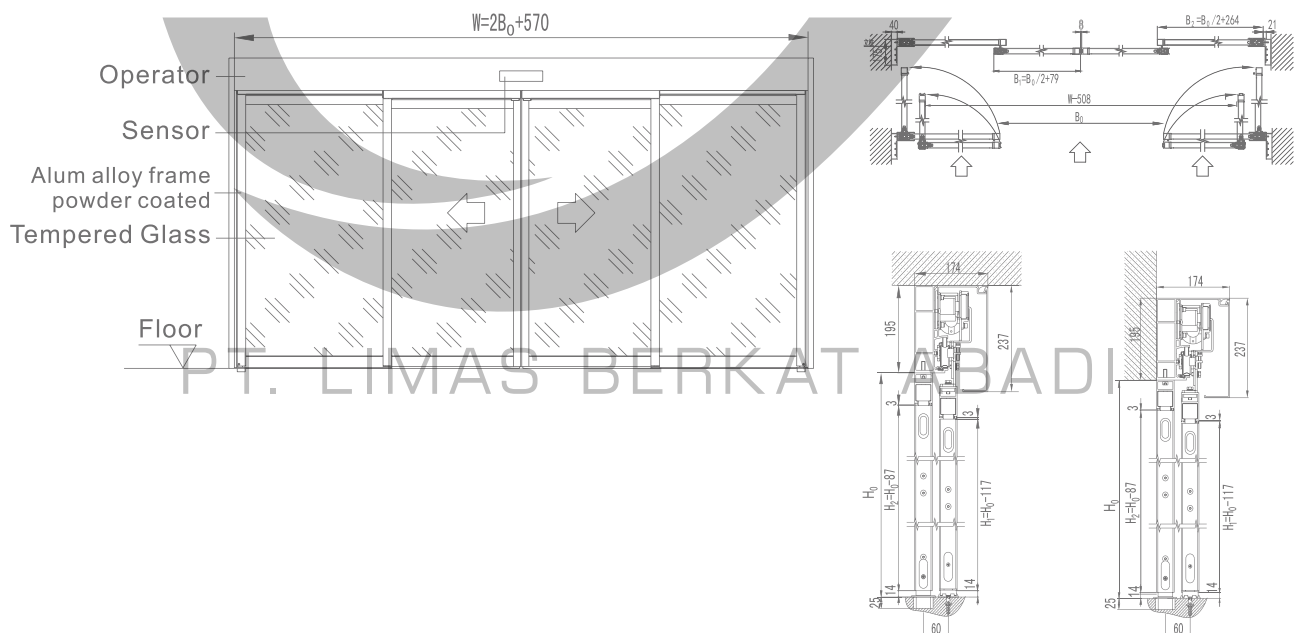

Almar Automatic Telescopic Door

- Applicable to wide open passageway, best utilize the entrance space.
- Integrated microcontroller chip, detect signals from sensors. Functional programmable and adjustable according to door size & weight.
- Operating quietly and fast, and whenever obstructions happen during its operation cycle, the door will rebound automatically to ensure the safety of passengers.
- Unique motor with self-locking system, it works well as entry access control without extra mechanical lock.
- Remote control function. All adjustments can be done with remote control easily.

Door Type	Single	Double
Operator Standard Length	2 x 150kg	4 x 100kg
Standard Height	DW= 1200 - 2700 mm	DW= 2200 - 3900 mm
Voltage	AC 220 V \pm 10%, 50-60 Hz	
OpeningSpeed	300 - 500 mm/s (Adjustable)	
Closing Speed	200 - 500 mm/s (Adjustable)	
Open Delay Time	2 - 20 s (Adjustable)	
Manual Open Force	100 N	
Power Consumption	< 150 W	
Working Temperature	-20 - 49 C	
Retardant Speed	Automatic	
Or custom size/model		

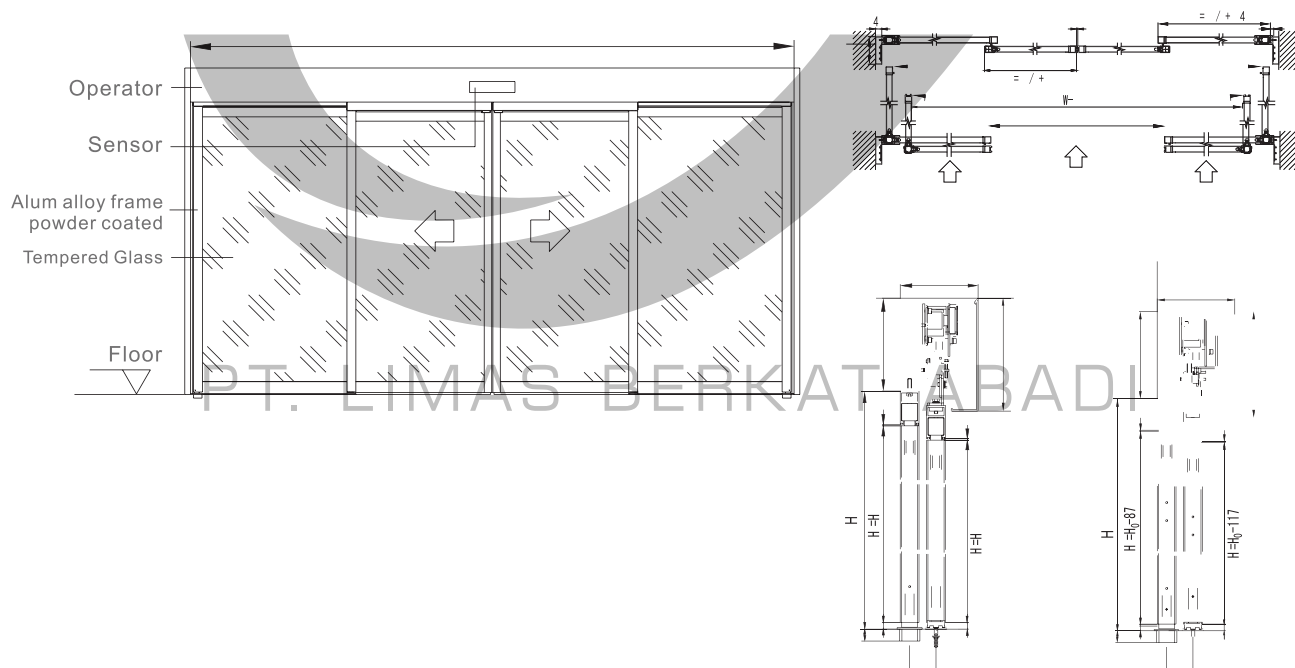



Almar Contact Less Sensor

- Detection Area : 10 - 40 cm (adjustable)
- Feature : Good anti-interference performance, clean and neat, not affected by color, temperature or radiation of object.
- Application : Automatic doors of operating rooms or labs for specific assigned person.



Almar Microwave Sensor

- Adjustable according to setting range.
- Feature : Wide range detection, high sensitivity, only be effective against moving object.
- Application : Automatic doors of hotels, banks, offices, factories where people pass in & out frequently.



Almar Foot Sensor

- Detection Area : Door Open / close by tiptoe touch.
- Feature : Automatic door open/ close after the tiptoe touch.
- Application : Automatic doors of operating rooms or labs for specific assigned person.



Almar Card Reader

- Feature : Secure, convenient and reliable.
- Application : Particular places need to control access.

PT LIMAS BERKAT ABADI

Insulate Panel System

A. Expanded Polystyrene (EPS) Panel

The self-extinguishing, fire retardant EPS foam is manufactured from 100% virgin bead and oven-cured after manufacture to ensure the resulting blocks are completely dry and free from all residual pentane.

EPS is a lightweight, CFC-free, non-brittle, closed cell insulator with more consistent thermal performance over time. It has a high dimensional stability and low water vapor transmission.

A special chemical coated to the Expanded Polystyrene beads (raw material) distinguished it from standard / common EPS.

Product Features

Core	: EPS.
Joint System	: Slip joint.
Density	: 15 & 20 kg/m ³ .
Width	: 1160 mm.
Thickness	: 50, 75, 100, 150, 200, 250 mm.
Length	: Up to 12 m.
Finishes	: Plain, Ribbed.
Steel Grade	: G300.
Steel Type	: Z275, Z180, AZ150, AZ100.
Standard Colors	: Off white (others are available).
Finishing Coating	: Antibacterial, Food grade, Exterior.
Most Common Steel	: 0.6 mm (Other thickness (base metal are available) Thickness-BMT).

Advantages

- Fire Retardant.
- Meets safety requirements.
- Energy saving.
- Longer lifetime.
- Customized Design.
- Resistant to termites and rodents.
- High performance on insulated panel.
- Easy to install-saving time & cost of instalation.

Thickness (mm)	50	75	100	150	200	250
Mass (Kg/m ²)	11.3	11.6	12	12.7	13.3	14
Thermal Performance (Properties at 6°)						
U Value (W/m ² K)	0.76	0.51	0.38	0.25	0.19	0.15
R Value (m ² K/W)	1.32	1.92	2.63	3.95	5.26	6.58

INSULATE PANEL SYSTEM

B. Polyisocyanurate (PIR) Panel

Polyisocyanurate (PIR) is a type of fire retardant panel, in the event of fire, PIR simply chars. Properly installed PIR panels can significantly reduce serious risks of property damage and loss of business due to fire. PIR panels are wall, ceiling, roofing, and insulation in one with a fire retardant polyisocyanurate (PIR) core.

PIR panel is recommended, where factory mutual (FM) approved panel is required for insurance purposes.

PIR panel suitable for all insulated panel applications, including cold storage. The PIR panels are now manufactured in Indonesia. Its fire risk reduction qualities have been proven to meet specifications in Australia, Europe and USA.



Product Features

Core : PIR.
Joint System : Slip joint.
Density : 40 - 42 kg/m³.
Width : 1170 mm (wall & ceiling).
Thickness : 50, 75, 100, 150, 200 mm.
Length : Up to 12 m.
Finishes : Plain, Ribbed, Diamond.
Steel Grade : G300.
Steel Type : Z275, Z180, AZ150, AZ100.
Standard Colors : Off white (others are available).
Finishing Coating : Antibacterial, Food grade, Exterior, Stainless steel.
Most Common Steel : 0.45, 0.6 mm (Other thickness (base metal are available) Thickness-BMT).

Advantages

- Meets safety requirements.
- Energy saving.
- Longer lifetime.
- Customized Design.
- Resistant to termites and rodents.
- High performance on insulated panel.
- Easy to install-saving time & cost of installation.

Thickness (mm)	50	75	100	150	200
Mass (Kg/m ²)	12.75	13.88	15	17.25	19.50
Thermal Performance (Properties at 22.5°)					
U Value (W/m ² K)	0.5	0.33	0.25	0.17	0.125
R Value (m ² K/W)	2.00	3.00	4.00	6.00	8.00

C. Mineral Wool Panel

Mineral wool panels are sandwich panels with steel faces and core of mineral wool fiberboard. The mineral wool panels are non-ozone-depleting, non-combustible sandwich panels manufactured with a core of mineral wool fiber.

The core manufactured with the fibers oriented across the thickness of the panel to maximize its structural strength. The insulation products are non-combustible with a melting point more than 1,000 degree Celsius. They are particularly suitable for thermal insulation, fire protection and sound reduction/absorption.

Mineral wool panels can be used as a wall and ceiling panels in building where improved fire performance is required.



Product Features

Core	: Mineral wool.
Joint System	: Slip joint.
Density	: 1000 kg/m ³ .
Width	: 1160 mm.
Thickness	: 50, 75, 100 mm.
Length	: Up to 6 m.
Finishes	: Plain, Ribbed.
Steel Grade	: G300.
Steel Type	: Z275, Z180, AZ150, AZ100.
Standard Colors	: Off white (others are available).
Finishing Coating	: Antibacterial, Food grade exterior.
Most Common Steel	: 0.6 mm (Other thickness (base metal are available) Thickness-BMT).

Advantages

- Dimensionally stable & not liable to shrink or expand.
- Chemically neutral & doesn't cause or promote corrosion.
- Easy to handle & cut.
- Fully recyclable, Non-combustible.
- Water repellent, non-hygroscopic & non capillary.
- Has Excellent sound absorbing properties.
- Not conducive to mold vermin & rot-proof.
- Resistant to termites & rodents.
- No asbestos, CFC & HCFC.

Thickness (mm)	50	75	100
Mass (Kg/m ²)	15.5	18	20.5
Thermal Performance (Properties at 22.5°)			
U Value (W/m ² K)	0.84	0.56	0.42
R Value (m ² K/W)	1.19	1.78	2.38

Joint System & Accessoris

Joints

Almar joint system called "SLIP JOINT" that panel to panel as male, female, with slip joint.

All joints are designed and fabricated to ensure integrity of insulation and vapor seal. Slip Joint® is used for Expanded Polystyrene (EPS), Polyisocyanurate (PIR), and Mineral Wool Panels.

Joints between vertical wall panels use the Slip Joint® system. Silicon shall be applied liberally to the panel skin edge prior to each panel's erection.

Joints are capped and fixed with powder-coated aluminium or folded steel flashing as necessary.

Advantages

- Has the ability to increase joint strength and
- the bonding of panels.
- Enables superior vapor barrier.
- Shortened panel installation time and decrease
- the usage of support structure.
- Reduce noise pollution .
- Offers panel lengths to suit any project size.
- Better architectural performance.

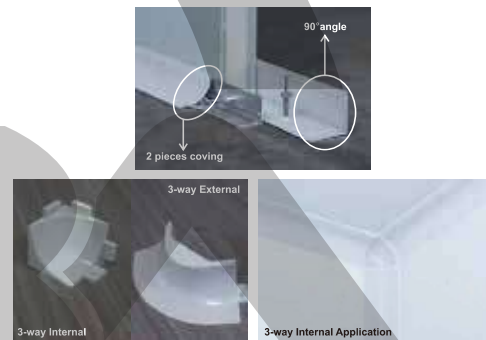

Fixing

All rivets used are totally blind, sealed aluminum encased rivets of a size approximate to the location and specific application. In general, 4 mm diameter rivets at around 300 mm centers shall be regarded as the requirement.

For clean room application, choices between no rivet expose or countersunk rivets are available.

Connection between panels, ceiling, and floors in clean room use 2 pieces coving with 45 mm diameter, or 90° angle and PVC/ Polyacetal 3-way corners to meet clean room requirements for cleanliness and hygiene.

PT. LIMAS BERKAT ABADI



Safety Against Fire

All Insulated Panel Systems provide excellent safety against fire.

They test property loss prevention products and services for use in commercial and industrial facilities to verify our product meet rigorous loss prevention standards of quality, technical integrity and performance.

Insulated Panel Systems you can protect your building, the people and the high value goods and machineries inside.

This safety against fire feature increases your peace of mind and reduces insurance costs.



Aluminium Extrusions

The high grade aluminium extrusions used in ALMAR Insulated Panel Systems are specially designed for a wide range of applications, such as clean room, cold storage and modular building. The use of high grade aluminium provides a stronger, durable extrusions.

For clean room application, the design of the extrusion is suitable to fulfill the requirement of Good Manufacturing Practice (GMP/CPOB - Cara Pembuatan Obat yang Baik) as required by the National Agency of Drug and Food Control (Badan Pengawas Obat dan Makanan RI - BPOM).

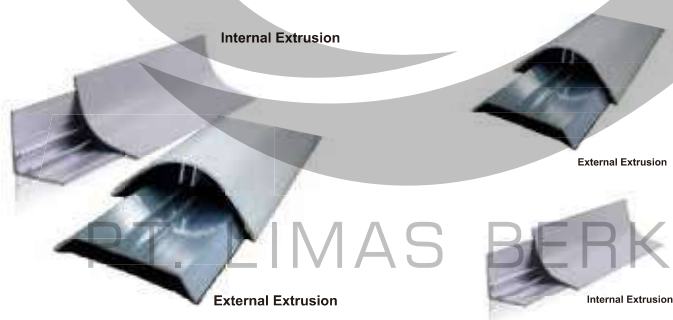

HRP Antibacterial

General Description

HRP Antibacterial™ is a pre-painted steel with hot dipped aluminum-zinc alloy coated substrate with food grade and antibacterial feature on top surface.

Typical Uses

For clean room or hygiene building application.

Indonesia Standard

SNI 4096:2007 Baja lembaran dan gulungan lapis paduan Aluminium - seng (Bj.LAS)

SNI 8305:2016 Baja lembaran dan gulungan lapis paduan aluminium dan seng dengan atau tanpa magnesium lapis cat atau laminasi (Bj. LAS warna/Bj,LASM warna)

Product Information

Substrate	G300 AZ100 steel (Aluminum-Zinc alloy-coated steel) (Refer to note 8)
Pre Treatment	Corrosion resistant proprietary conversion coating
Primer Coat	Universal corrosion inhibitive primer. Nominal dry film thickness 5µm each side
Finish Coat	Custom formulated super polyester paint system with high performance pigments. Nominal dry film thickness 17µm on the top or weather side
Backing Coat	Custom formulated Foam Grey. Nominal dry film thickness 5µm
Colour	Putih Ampupu

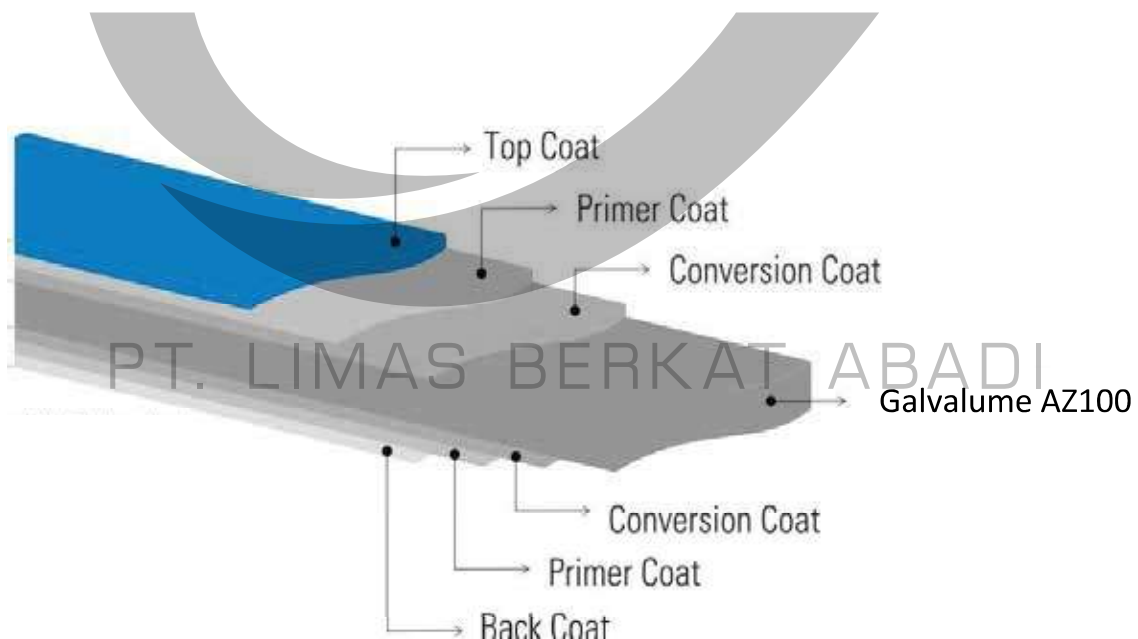

TEST RESULT CERTIFICATION

[illegible]

 KEMENTERIAN PEKERJAAN UMUM DAN PERUMAHAN RAKYAT DIREKTORAT JENDERAL CIPTA KARYA DIREKTORAT BINA TEKNOLOGI DAN PERUMAHAN Jl. Patimura No. 78, ANJAYAN RAYA, JAKARTA BARAT	
LAPORAN HASIL PENGUKURAN	
Nama Lokasi	107 A3.3044.0330
Nama Subkontrakan	1.000000000000 - Jasa Ukur Bangunan Sederhana
Jenis Pekerjaan	Pengukuran Luas dan Perimeter Sederhana
Waktu Pengukuran	07 Oktober 2020
Tanggal Pengukuran	20 Oktober 2020
Profil	Daerah Perkotaan Kota
Jumlah	1 buah
Detail/Kondisi Sampel	Bentuk bangunan yang akan diukur adalah persegi panjang dengan dimensi 1,5 m x 1,5 m. Bangunan ini adalah bangunan permanen yang terbuat dari beton. Bangunan ini memiliki luas lantai 2,25 m². Bangunan ini memiliki tinggi 2,5 m.
Detail Lokasi	RT 10/000, RW 001, KEC. ANJAYAN
Alamat	Ruko Mandiri No. 7, Jl. Patimura, Jakarta Barat
Standar Referensi	SN 197-2008
Metode Pengukuran	Teknik Hidrometri (H2O) (T001) (T002) (T003) (T004) (T005) (T006) (T007) (T008) (T009) (T010) (T011) (T012) (T013) (T014) (T015) (T016) (T017) (T018) (T019) (T020) (T021) (T022) (T023) (T024) (T025) (T026) (T027) (T028) (T029) (T030) (T031) (T032) (T033) (T034) (T035) (T036) (T037) (T038) (T039) (T040) (T041) (T042) (T043) (T044) (T045) (T046) (T047) (T048) (T049) (T050) (T051) (T052) (T053) (T054) (T055) (T056) (T057) (T058) (T059) (T060) (T061) (T062) (T063) (T064) (T065) (T066) (T067) (T068) (T069) (T070) (T071) (T072) (T073) (T074) (T075) (T076) (T077) (T078) (T079) (T080) (T081) (T082) (T083) (T084) (T085) (T086) (T087) (T088) (T089) (T090) (T091) (T092) (T093) (T094) (T095) (T096) (T097) (T098) (T099) (T100) (T101) (T102) (T103) (T104) (T105) (T106) (T107) (T108) (T109) (T110) (T111) (T112) (T113) (T114) (T115) (T116) (T117) (T118) (T119) (T120) (T121) (T122) (T123) (T124) (T125) (T126) (T127) (T128) (T129) (T130) (T131) (T132) (T133) (T134) (T135) (T136) (T137) (T138) (T139) (T140) (T141) (T142) (T143) (T144) (T145) (T146) (T147) (T148) (T149) (T150) (T151) (T152) (T153) (T154) (T155) (T156) (T157) (T158) (T159) (T160) (T161) (T162) (T163) (T164) (T165) (T166) (T167) (T168) (T169) (T170) (T171) (T172) (T173) (T174) (T175) (T176) (T177) (T178) (T179) (T180) (T181) (T182) (T183) (T184) (T185) (T186) (T187) (T188) (T189) (T190) (T191) (T192) (T193) (T194) (T195) (T196) (T197) (T198) (T199) (T200) (T201) (T202) (T203) (T204) (T205) (T206) (T207) (T208) (T209) (T210) (T211) (T212) (T213) (T214) (T215) (T216) (T217) (T218) (T219) (T220) (T221) (T222) (T223) (T224) (T225) (T226) (T227) (T228) (T229) (T230) (T231) (T232) (T233) (T234) (T235) (T236) (T237) (T238) (T239) (T240) (T241) (T242) (T243) (T244) (T245) (T246) (T247) (T248) (T249) (T250) (T251) (T252) (T253) (T254) (T255) (T256) (T257) (T258) (T259) (T260) (T261) (T262) (T263) (T264) (T265) (T266) (T267) (T268) (T269) (T270) (T271) (T272) (T273) (T274) (T275) (T276) (T277) (T278) (T279) (T280) (T281) (T282) (T283) (T284) (T285) (T286) (T287) (T288) (T289) (T290) (T291) (T292) (T293) (T294) (T295) (T296) (T297) (T298) (T299) (T300) (T301) (T302) (T303) (T304) (T305) (T306) (T307) (T308) (T309) (T310) (T311) (T312) (T313) (T314) (T315) (T316) (T317) (T318) (T319) (T320) (T321) (T322) (T323) (T324) (T325) (T326) (T327) (T328) (T329) (T330) (T331) (T332) (T333) (T334) (T335) (T336) (T337) (T338) (T339) (T340) (T341) (T342) (T343) (T344) (T345) (T346) (T347) (T348) (T349) (T350) (T351) (T352) (T353) (T354) (T355) (T356) (T357) (T358) (T359) (T360) (T361) (T362) (T363) (T364) (T365) (T366) (T367) (T368) (T369) (T370) (T371) (T372) (T373) (T374) (T375) (T376) (T377) (T378) (T379) (T380) (T381) (T382) (T383) (T384) (T385) (T386) (T387) (T388) (T389) (T390) (T391) (T392) (T393) (T394) (T395) (T396) (T397) (T398) (T399) (T400) (T401) (T402) (T403) (T404) (T405) (T406) (T407) (T408) (T409) (T410) (T411) (T412) (T413) (T414) (T415) (T416) (T417) (T418) (T419) (T420) (T421) (T422) (T423) (T424) (T425) (T426) (T427) (T428) (T429) (T430) (T431) (T432) (T433) (T434) (T435) (T436) (T437) (T438) (T439) (T440) (T441) (T442) (T443) (T444) (T445) (T446) (T447) (T448) (T449) (T450) (T451) (T452) (T453) (T454) (T455) (T456) (T457) (T458) (T459) (T460) (T461) (T462) (T463) (T464) (T465) (T466) (T467) (T468) (T469) (T470) (T471) (T472) (T473) (T474) (T475) (T476) (T477) (T478) (T479) (T480) (T481) (T482) (T483) (T484) (T485) (T486) (T487) (T488) (T489) (T490) (T491) (T492) (T493) (T494) (T495) (T496) (T497) (T498) (T499) (T500) (T501) (T502) (T503) (T504) (T505) (T506) (T507) (T508) (T509) (T510) (T511) (T512) (T513) (T514) (T515) (T516) (T517) (T518) (T519) (T520) (T521) (T522) (T523) (T524) (T525) (T526) (T527) (T528) (T529) (T530) (T531) (T532) (T533) (T534) (T535) (T536) (T537) (T538) (T539) (T540) (T541) (T542) (T543) (T544) (T545) (T546) (T547) (T548) (T549) (T550) (T551) (T552) (T553) (T554) (T555) (T556) (T557) (T558) (T559) (T560) (T561) (T562) (T563) (T564) (T565) (T566) (T567) (T568) (T569) (T570) (T571) (T

ONE STOP SOLUTION

- Return Grill
- Information panel with X-RAY viewer
- OT Wall (SGP Panel)
- Conductive PCV Tile
- Electrical Socket for Medical Use
- Relief Damper
- Pass Box
- Ceiling Pendant (Endoscopy)
- UV Light
- UPS System





- Maintenance Service Technical Hole
- Medical Cabinet
- X-RAY Viewer
- Return Grill
- Medical Pass Cabinet
- Ceiling Pendant (Anesthesia)
- IPS (Isolated Power System)
- Indicator Light
- Hermetic Single Door
- Nurse Call
- OT Clock
- Scrub sink
- Foot Switch

ALL DOOR LAYOUT 3D

AUTOMATIC DOOR FOR EMERGENCY EVACUATION

AUTOMATIC SLIDING DOOR

SANDWICH PANEL SINGLE

ALUMUNIUUM DOOR SINGLE

STAINLES STEEL DOOR DOUBLE

STAINLESS STEEL
DOOR SINGLE

AUTOMATIC TELESCOPIC DOOR

PT LIMAS BERKAT ABADI

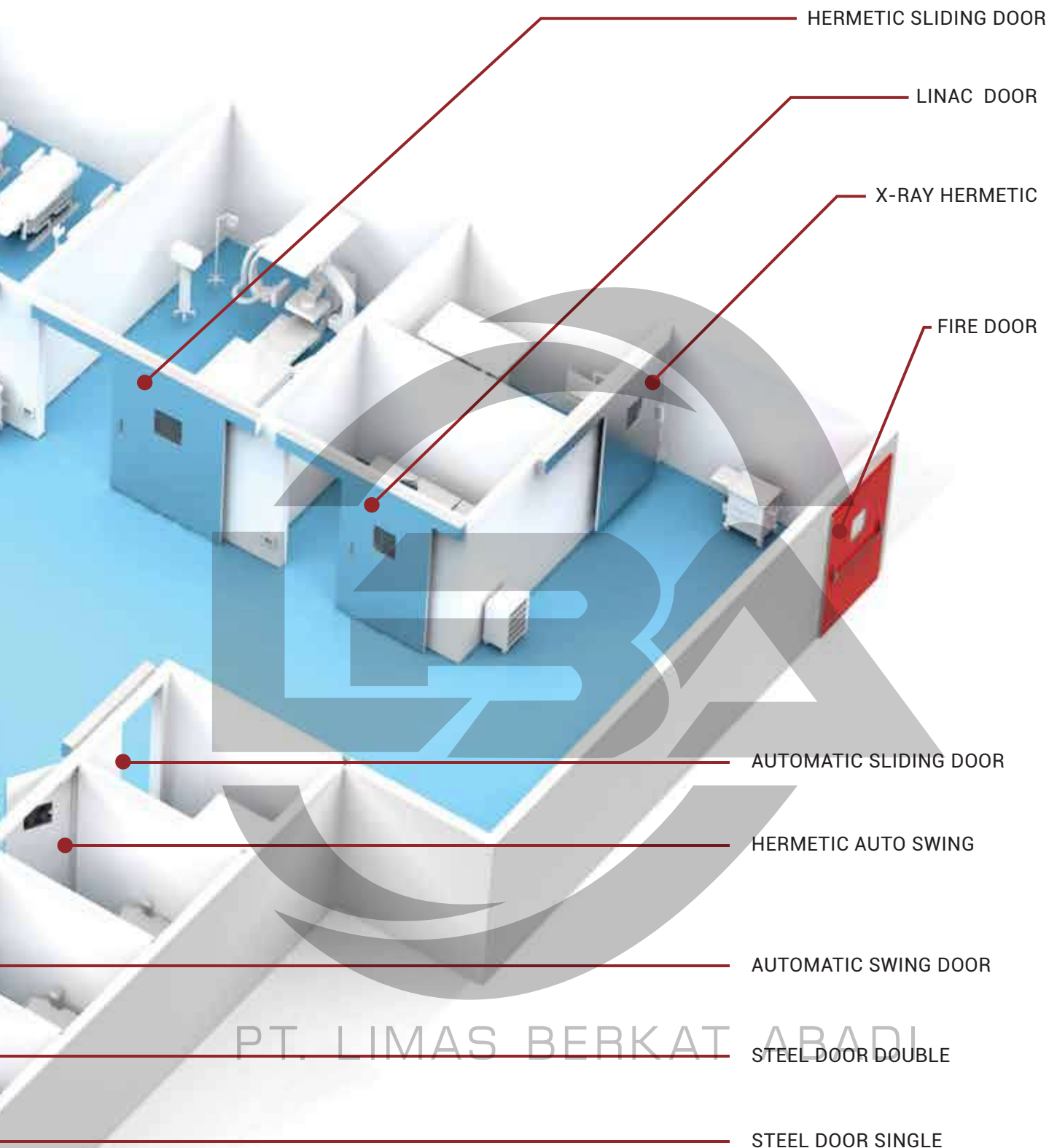

ALMAR MEDICAL DOOR series offers a full range of hospital hygienic door system for integrated solutions. Different from the general building management, hospital systems require specific functions for different areas of public health care services to ensure the accessibility of the channel and path.

PRODUCT REFERENCE

Single Fire Door



Double Fire Door



Double Steel Door



Single Stainless Steel SUS 304 Door



Single Sandwich Panel Door



Shaft Door



Jalusi / Steel Louvre



Single Automatic Swing Door



Hermetic Auto Sliding Door



Hermetic Auto Swing Door



Hermetic X-Ray Auto Sliding Door



ICU/HCU Automatic Sliding Door



Linac Door



Automatic Door for Emergency Evacuation



Automatic Telescopic Door



PT. LIMAS BERRA ABADI

Almar Scrub Sink



Almar Pass Box



Almar Medical Storage Cabinet



Almar Power Ground Module



Almar PB Lead Sheet



Almar PB Glass (Anti-radiation Glass)



Almar Information Panel



Almar X-Ray Viewer



Almar Control Panel



Almar LED Light



Almar Contact Less Sensor



Almar LED Operating Timer



Almar Microwave Sensor



Almar Foot Sensor



Almar Card Reader



PT. LIMAS BERKAT ABADI

PROJECT REFERENCE



RSA. UGM



EKA HOSPITAL



RS MEDIKA PERMATA HIJAU



RSUD DR. H. KUMPULAN PANE



RSUD SOREANG



RSUD PROVINSI SULAWESI UTARA



MAYAPADA HOSPITAL



RSUD DR. ACHMAD MOCHTAR



RSUD R. SYAMSUDIN, SH



RSUP DR. SARDJITO



GAPURA ANGKASA OFFICE



RSUD MARIA WALANDA MARAMIS



BMC MAYAPADA HOSPITAL



CIPUTRA MITRA HOSPITAL BANJARMASIN



LAB C-GMP BRIN



MAYAPADA HOSPITAL BANDUNG



RS ADI HUSADA KAPASARI



RS ADI HUSADA SURABAYA



RS JANTUNG TASIKMALAYA



RS NURUSSYIFA SEMARANG



RS PANTI WALUYA SAWAHAN



RS PERMATA HATI METRO



RS PKU SOLO



RS UKRIDA

PT. LIMAS BERKAT ABADI



RS UPT VERTIKAL KUPANG



RSI JEMURSARI SURABAYA



RSIA ASIH



RS PUSAT PERTAMINA



RSU ANDHIKA



RSU BAITUL HIKMAH



RSUD MAMUJU



RSUD MEURAXA



RSUD PAMBALAH BATUNG



RSUP FATMAWATI



RSUP WAHIDIN SUDIROHUSODO MAKASSAR



RS PERMATA KELUARGA

PT. LIMAS BERKAT ABADI



RSUD MANADO



MAKO POLRES TANGERANG KOTA



RS KANKER DHARMAIS



RSUP NASIONAL DR. CIPTO MANGUNKUSUMO



UNIV. MUHAMMADIYAH JEMBER



RSUD DR. KANUJOSO DJATIWOBOWO
BALIKPAPAN



THE GAIA HOTEL BANDUNG



TAMAN MINI INDONESIA INDAH

AND MANY MORE...

PT. LIMAS BERKAT ABADI

PARTNERSHIP



PT. LIMAS BERKAT ABADI





PT. LIMAS BERKAT ABADI

PT. LIMAS BERKAT ABADI

Ruko Ayodhya Square Blok A No.15
Jl. MH Thamrin Cikokol, Tangerang (15117)

Contact us :

0815 4614 9393
0878 8859 6964

limasberkatabadi@gmail.com